



- 1
- 2
- 3
- 4
- 5
- 6
- 7
- 8
- 9
- 10
- 11
- 12
- 13
- 14
- 15
- 16
- 17
- 18

STANDARD EXECUTIONS

- **DVA.2:** bushing with threaded blind hole, threaded stud and base plate in polished zinc-plated steel, vibration-damper body in natural rubber NR, black colour, hardness 40, 55, 70 Shore A ± 5 .
- **DVA.2-SST:** bushing with threaded blind hole, threaded stud and base plate in AISI 304 stainless steel, vibration-damper body in natural rubber NR, black colour, hardness 55 Shore A ± 5 .

FEATURES AND APPLICATIONS

The rubber buffers have been designed to damp vibrations, shocks and noises produced by moving bodies or non-balanced vibrating masses of equipment and machines which can cause:

- malfunctioning and reduction of the machine lifespan and/or of the adjacent ones;
- damage to health;
- noise.

Load diagrams for each single code are available on request. See Technical data and guidelines for the choice (on page 728).

SPECIAL EXECUTIONS ON REQUEST

Natural rubber NR, hardness 40, 70 tolerance ± 5 Shore A for executions with AISI 304 stainless steel base.

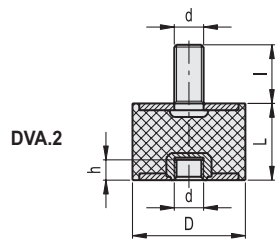

Conversion Table					
1 mm = 0.039 inch					
D			L		
mm	inch	mm	inch	mm	inch
6	0.23	50	1.97	7	0.27
8	0.31	60	2.36	8	0.31
10	0.39	70	2.76	10	0.39
15	0.59	75	2.95	13	0.51
20	0.79	80	3.12	15	0.59
25	0.98	100	3.94	20	0.79
30	1.18	125	4.92	25	0.98
40	1.57	125	4.92	30	1.18

* Complete the description with the desired hardness: 40, 55 or 70 tolerance ± 5 Shore A.

DVA.2 - 8 - 8 - M3 - 6 - 55
 D L d l Shore A

DVA.2



Description	D	L	d	l	h	⚖	Hardness 40 Shore A			Hardness 55 Shore A			Hardness 70 Shore A					
							Code	Max load [N]	Max deflection [mm]	Stiffness [N/mm]	Code	Max load [N]	Max deflection v	Stiffness [N/mm]	Code	Max load [N]	Max deflection [mm]	Stiffness [N/mm]
DVA.2-6-7-M3-6-*	6	7	M3	6	3	1	414291	34	2	19	411681	265	2	151	417000	628	1.8	359
DVA.2-8-8-M3-6-*	8	8	M3	6	3	1	414301	50	2	25	411701	85	2	43	417001	150	2	75
DVA.2-8-13-M3-6-*	8	13	M3	6	3	2	414303	38	3	12	411703	70	3	21	417003	145	3	45
DVA.2-10-10-M4-10-*	10	10	M4	10	4	2	414311	75	3	30	411721	100	3	40	417011	200	3	80
DVA.2-10-15-M4-10-*	10	15	M4	10	4	3	414321	65	4	17	411731	100	4	27	417021	150	4	40
DVA.2-10-20-M4-10-*	10	20	M4	10	4	3	414323	59	5	12	411733	93	5	19	417023	132	5	26
DVA.2-15-10-M4-10-*	15	10	M4	10	4	5	414331	210	2	105	411741	325	2	163	417031	717	2	359
DVA.2-15-15-M4-10-*	15	15	M4	10	4	6	414341	155	4	41	411761	280	4	75	417041	513	4	137
DVA.2-15-20-M4-10-*	15	20	M4	10	4	7	414351	151	5	30	411771	234	5	47	417051	468	5	94
DVA.2-15-25-M4-10-*	15	25	M4	10	4	8	414353	133	6	21	411773	234	6	37	417053	505	6	81
DVA.2-15-30-M4-10-*	15	30	M4	10	4	10	414355	149	7	20	411776	215	7	29	417056	460	7	61

Vibration damping elements

Conversion Table							
1 mm = 0.039 inch							
D				L			
mm	inch	mm	inch	mm	inch	mm	inch
6	0.23	50	1.97	7	0.27	40	1.57
8	0.31	60	2.36	8	0.31	45	1.77
10	0.39	70	2.76	10	0.39	50	1.97
15	0.59	75	2.95	13	0.51	55	2.17
20	0.79	80	3.12	15	0.59	60	2.36
25	0.98	100	3.94	20	0.79	75	2.95
30	1.18	125	4.92	25	0.98		
40	1.57	125	4.92	30	1.18		

METRIC

DVA.2

Description	D	L	d	l	h	△	Hardness 40 Shore A			Hardness 55 Shore A			Hardness 70 Shore A					
							Code	Max load [N]	Max deflection [mm]	Stiffness [N/mm]	Code	Max load [N]	Max deflection v	Stiffness [N/mm]	Code	Max load [N]	Max deflection [mm]	Stiffness [N/mm]
DVA.2-20-15-M6-18-*	20	15	M6	18	6	15	414361	322	4	86	411781	479	4	128	417061	1044	4	278
DVA.2-20-20-M6-18-*	20	20	M6	18	6	17	414371	220	5	44	411801	430	5	86	417071	995	5	199
DVA.2-20-25-M6-18-*	20	25	M6	18	6	18	414381	264	6	42	411811	433	6	69	417081	1010	6	162
DVA.2-20-30-M6-18-*	20	30	M6	18	6	21	414383	261	8	35	411813	417	8	56	417083	1213	8	162
DVA.2-25-15-M6-18-*	25	15	M6	18	6	26	414391	860	4	229	411821	1068	4	285	417091	2690	4	717
DVA.2-25-20-M6-18-*	25	20	M6	18	6	28	414401	391	5	78	411841	620	5	124	417101	1533	5	307
DVA.2-25-30-M6-18-*	25	30	M6	18	6	36	414411	432	8	58	411851	524	8	70	417111	1208	8	161
DVA.2-30-15-M8-20-*	30	15	M8	20	8	41	414421	986	4	263	411861	2100	1	1400	417121	2700	1.5	1800
DVA.2-30-20-M8-20-*	30	20	M8	20	8	43	414431	1300	5	260	411881	3070	5	614	417131	2000	2.75	727
DVA.2-30-25-M8-18-*	30	25	M8	18	8	46	414436	790	6	126	411886	1260	6	202	417136	2650	6.3	424
DVA.2-30-30-M8-20-*	30	30	M8	20	8	50	414441	500	8	67	411901	1055	8	141	417141	1960	8	261
DVA.2-30-40-M8-20-*	30	40	M8	20	8	60	414443	591	10	59	411903	932	10	93	417143	2000	10	200
DVA.2-40-20-M8-23-*	40	20	M8	23	8	73	414451	3490	5	698	411911	2200	3	628	417151	10160	5	2032
DVA.2-40-20-M10-23-*	40	20	M10	23	10	72	414476	3660	5	732	411951	21050	5	4210	417173	10220	5	2044
DVA.2-40-28-M10-23-*	40	28	M10	23	10	78	414477	1318	7	188	411953	3020	7	431	417174	5980	7	854
DVA.2-40-30-M8-23-*	40	30	M8	23	8	85	414461	1137	8	152	411921	1574	8	210	417161	3420	8	456
DVA.2-40-35-M10-23-*	40	35	M10	23	10	90	414478	1328	9	152	411955	2090	9	239	417175	3390	8.8	387
DVA.2-40-40-M8-23-*	40	40	M8	23	8	98	414471	1056	10	106	411941	1397	10	140	417171	3190	10	319
DVA.2-40-40-M10-23-*	40	40	M10	23	10	97	414479	1070	10	107	411957	1873	10	187	417176	2100	10	210
DVA.2-50-20-M10-28-*	50	20	M10	28	10	115	414481	11610	5	2322	411961	14030	5	2806	417181	22540	5	4508
DVA.2-50-25-M10-28-*	50	25	M10	28	10	120	414486	3900	6	624	411971	5540	6	886	417186	12020	6.3	1923
DVA.2-50-30-M10-28-*	50	30	M10	28	10	135	414491	2010	8	268	411981	3300	8	440	417191	5450	8	727
DVA.2-50-35-M10-28-*	50	35	M10	28	10	145	414496	2245	9	257	411991	3270	9	374	417196	7980	8.8	912
DVA.2-50-40-M10-28-*	50	40	M10	28	10	160	414501	1477	10	148	412001	2130	10	213	417201	4940	10	494
DVA.2-50-45-M10-28-*	50	45	M10	28	10	170	414511	1368	11	122	412021	2046	11	182	417211	2580	11	229
DVA.2-50-50-M10-28-*	50	50	M10	28	10	185	414521	1500	13	120	412026	2188	13	175	417221	4750	13	380
DVA.2-60-30-M10-28-*	60	30	M10	28	10	199	414531	3020	8	403	412031	4170	8	556	417231	9130	8	1217
DVA.2-60-36-M10-28-*	60	36	M10	28	10	198	414536	2940	9	327	412033	5000	9	555	417236	9370	9	1041
DVA.2-60-40-M10-28-*	60	40	M10	28	10	220	414541	2520	10	252	412036	3610	10	361	417241	6950	10	695
DVA.2-60-50-M10-28-*	60	50	M10	28	10	245	414543	2650	13	212	412039	3410	13	273	417243	6570	13	526
DVA.2-70-30-M10-28-*	70	30	M10	28	10	329	414550	5940	8	792	412040	8570	8	1143	417250	24010	7	3382
DVA.2-70-45-M10-28-*	70	45	M10	28	10	372	414551	3810	11	339	412041	7130	11	634	417251	13210	11	1174
DVA.2-70-50-M10-27-*	70	50	M10	27	10	377	414553	4300	12	344	411683	5930	12	474	417253	14150	12.5	1132
DVA.2-70-70-M10-27-*	70	70	M10	27	10	382	414556	3500	17	200	412046	5010	17	286	417255	8400	17.5	480
DVA.2-75-25-M12-37-*	75	25	M12	37	12	321	414561	6150	4	1537	412051	10000	3	3333	417261	15900	3	5300
DVA.2-75-40-M12-37-*	75	40	M12	37	12	385	414571	4910	10	491	412061	6970	10	697	417271	14800	8	1850
DVA.2-75-45-M12-37-*	75	45	M12	37	12	390	414573	5070	11	451	412071	7050	11	627	417273	15510	11.3	1379
DVA.2-75-50-M12-37-*	75	50	M12	37	12	405	414576	4240	12	339	412076	7010	12	561	417276	15010	12.5	1201
DVA.2-75-55-M12-37-*	75	55	M12	37	12	450	414581	3470	14	252	412081	7510	14	546	417281	11240	14	817
DVA.2-80-40-M14-37-*	80	40	M14	37	14	510	414586	10430	10	1043	412091	16710	10	1671	417286	27700	10	2770
DVA.2-100-40-M16-41-*	100	40	M16	41	16	740	414591	13990	10	1399	412101	20000	10	2000	417291	29000	10	2900
DVA.2-100-55-M16-41-*	100	55	M16	41	16	850	414601	7320	14	532	412121	13080	14	951	417301	24260	14	1764
DVA.2-100-60-M16-41-*	100	60	M16	41	16	865	414611	7000	15	467	412141	11290	15	753	417311	28500	15	1900
DVA.2-100-75-M16-41-*	100	75	M16	41	16	980	414621	7790	19	415	412161	9640	19	514	417321	22350	19	1192
DVA.2-125-55-M16-41-*	125	55	M16	41	16	1320	414651	17600	14	1280	412181	19260	14	1401	417351	23610	8	3008
DVA.2-125-75-M16-41-*	125	75	M16	41	16	1600	414661	12760	19	681	412191	19440	19	1037	417361	24205	19	1291



Vibration damping elements

- 1
- 2
- 3
- 4
- 5
- 6
- 7
- 8
- 9
- 10
- 11
- 12
- 13
- 14
- 15
- 16
- 17
- 18

DVA.2 - 8 - 8 - SST - M3 - 6 - 55
 D L Stainless steel d l Shore A

DVA.2-SST

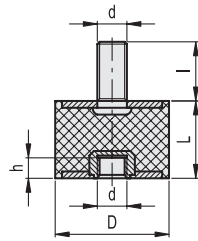

Conversion Table					
1 mm = 0.039 inch					
D			L		
mm	inch	mm	inch	mm	inch
6	0.23	50	1.97	7	0.27
8	0.31	60	2.36	8	0.31
10	0.39	70	2.76	10	0.39
15	0.59	75	2.95	13	0.51
20	0.79	80	3.12	15	0.59
25	0.98	100	3.94	20	0.79
30	1.18	125	4.92	25	0.98
40	1.57	125	4.92	30	1.18

DVA.2-SST

INOX STAINLESS STEEL METRIC

Description	D	L	d	l	h	⚖	Hardness 40 Shore A			Hardness 55 Shore A			Hardness 70 Shore A					
							Code	Max load [N]	Max deflection [mm]	Stiffness [N/mm]	Code	Max load [N]	Max deflection [mm]	Stiffness [N/mm]	Code	Max load [N]	Max deflection [mm]	Stiffness [N/mm]
DVA.2-6-7-SST-M3-6-55	6	7	M3	6	3	1		34	2	19	410100	265	2	151		628	2	359
DVA.2-8-8-SST-M3-6-55	8	8	M3	6	3	1		50	2	25	410101	85	2	43		150	2	75
DVA.2-8-13-SST-M3-6-55	8	13	M3	6	3	2		38	3	12	410103	70	3	21		145	3	45
DVA.2-10-10-SST-M4-10-55	10	10	M4	10	4	2		75	3	30	410105	100	3	40		200	3	80
DVA.2-10-15-SST-M4-10-55	10	15	M4	10	4	3		65	4	17	410107	100	4	27		150	4	40
DVA.2-10-20-SST-M4-10-55	10	20	M4	10	4	3		59	5	12	410109	93	5	19		132	5	26
DVA.2-15-10-SST-M4-10-55	15	10	M4	10	4	5		210	2	105	410113	325	2	163		717	2	359
DVA.2-15-15-SST-M4-10-55	15	15	M4	10	4	6		155	4	41	410115	280	4	75		513	4	137
DVA.2-15-20-SST-M4-10-55	15	20	M4	10	4	7		151	5	30	410117	234	5	47		468	5	94
DVA.2-15-25-SST-M4-10-55	15	25	M4	10	4	8		133	6	21	410119	234	6	37		505	6	81
DVA.2-15-30-SST-M4-10-55	15	30	M4	10	4	10		149	7.5	20	410120	215	7	29		460	7.5	61
DVA.2-20-15-SST-M6-18-55	20	15	M6	18	6	15		322	4	86	410121	479	4	128		1044	4	278
DVA.2-20-20-SST-M6-18-55	20	20	M6	18	6	17		220	5	44	410123	430	5	86		995	5	199
DVA.2-20-25-SST-M6-18-55	20	25	M6	18	6	18		264	6	42	410125	433	6	69		1010	6	162
DVA.2-20-30-SST-M6-18-55	20	30	M6	18	6	21		261	8	35	410127	417	8	56		1213	8	162
DVA.2-25-15-SST-M6-18-55	25	15	M6	18	6	26		860	4	229	410131	1068	4	285		2690	4	717
DVA.2-25-20-SST-M6-18-55	25	20	M6	18	6	28		391	5	78	410133	620	5	124		1533	5	307
DVA.2-25-30-SST-M6-18-55	25	30	M6	18	6	36		432	8	58	410137	524	8	70		1208	8	161
DVA.2-30-15-SST-M8-20-55	30	15	M8	20	8	41		986	4	263	410141	2080	4	555		3300	4	880
DVA.2-30-20-SST-M8-20-55	30	20	M8	20	8	43		1300	5	260	410143	3070	5	614		7540	5	1508
DVA.2-30-25-SST-M8-18-55	30	25	M8	18	8	46		790	6	126	410144	1260	6	202		2650	6	424
DVA.2-30-30-SST-M8-20-55	30	30	M8	20	8	50		500	8	67	410145	1055	8	141		1960	8	261
DVA.2-30-40-SST-M8-20-55	30	40	M8	20	8	60		591	10	59	410147	932	10	93		2000	10	200

ON REQUEST

ON REQUEST

Vibration damping elements

Conversion Table					
1 mm = 0.039 inch					
D			L		
mm	inch	mm	inch	mm	inch
6	0.23	50	1.97	7	0.27
8	0.31	60	2.36	8	0.31
10	0.39	70	2.76	10	0.39
15	0.59	75	2.95	13	0.51
20	0.79	80	3.12	15	0.59
25	0.98	100	3.94	20	0.79
30	1.18	125	4.92	25	0.98
40	1.57	125	4.92	30	1.18

DVA.2-SST



Description	D	L	d	l	h	⚖️	Hardness 40 Shore A			Hardness 55 Shore A			Hardness 70 Shore A					
							Code	Max load [N]	Max deflection [mm]	Stiffness [N/mm]	Code	Max load [N]	Max deflection [mm]	Stiffness [N/mm]	Code	Max load [N]	Max deflection [mm]	Stiffness [N/mm]
DVA.2-40-20-SST-M8-23-55	40	20	M8	23	8	73		3490	5	698	410151	8420	5	1684		10160	5	2032
DVA.2-40-20-SST-M10-23-55	40	20	M10	23	10	72		3660	5	732	410150	21050	5	4210		10220	5	2044
DVA.2-40-28-SST-M10-23-55	40	28	M10	23	10	72		1318	7	188	410152	3020	7	431.4		5980	7	854
DVA.2-40-30-SST-M8-23-55	40	30	M8	23	8	85		1137	8	152	410153	1574	8	210		3420	8	456
DVA.2-40-35-SST-M10-23-55	40	35	M10	23	10	90		1328	9	152	410154	2090	9	239		3390	9	387
DVA.2-40-40-SST-M8-23-55	40	40	M8	23	8	98		1056	10	106	410155	1397	10	140		3190	10	319
DVA.2-40-40-SST-M10-23-55	40	40	M10	23	10	97		1070	10	107	410156	1873	10	187.3		2100	10	210
DVA.2-50-20-SST-M10-28-55	50	20	M10	28	10	115		11610	5	2322	410161	14030	5	2806		22540	5	4508
DVA.2-50-25-SST-M10-28-55	50	25	M10	28	10	120		3900	69	624	410162	5540	6	886		12020	6	1923
DVA.2-50-30-SST-M10-28-55	50	30	M10	28	10	135		2010	8	268	410163	3300	8	440		5450	8	727
DVA.2-50-35-SST-M10-28-55	50	35	M10	28	10	145		2245	9	257	410164	3270	9	374		7980	9	912
DVA.2-50-40-SST-M10-28-55	50	40	M10	28	10	160		1477	10	148	410165	2130	10	213		4940	10	494
DVA.2-50-45-SST-M10-28-55	50	45	M10	28	10	170		1368	11	122	410167	2046	11	182		2580	11	229
DVA.2-50-50-SST-M10-28-55	50	50	M10	28	10	185		1500	13	120	410169	2188	13	175		4750	13	380
DVA.2-60-30-SST-M10-28-55	60	30	M10	28	10	199		3020	8	403	410171	4170	8	556		9130	8	1217
DVA.2-60-36-SST-M10-28-55	60	36	M10	28	10	220	ON REQUEST	2940	9	327	410174	5000	9	556	ON REQUEST	9370	9	1041
DVA.2-60-40-SST-M10-28-55	60	40	M10	28	10	198		2520	10	252	410173	3610	10	361		6950	10	695
DVA.2-60-50-SST-M10-28-55	60	50	M10	28	10	245		2650	13	212	410175	3410	13	273		6570	13	526
DVA.2-70-30-SST-M10-28-55	70	30	M10	28	10	329		5940	8	792	410176	8570	8	1143		24010	7	3382
DVA.2-70-45-SST-M10-28-55	70	45	M10	28	10	372		3810	11	339	410177	7130	11	634		13210	11	1174
DVA.2-70-50-SST-M10-27-55	70	50	M10	27	10	377		4300	12	344	410178	5930	12	474		14150	12	1132
DVA.2-70-70-SST-M10-27-55	70	70	M10	27	10	382		3500	17	200	410180	5010	17	286		8400	17	480
DVA.2-75-25-SST-M12-37-55	75	25	M12	37	12	321		6150	4	1537	410181	10000	3	3333		15900	3	5300
DVA.2-75-40-SST-M12-37-55	75	40	M12	37	12	385		4910	10	491	410183	6970	10	697		14800	8	1850
DVA.2-75-45-SST-M12-37-55	75	45	M12	37	12	390		5070	11	450.6	410184	7050	11	627		15510	11	1379
DVA.2-75-50-SST-M12-37-55	75	50	M12	37	12	405		4240	12	339.2	410186	7010	12.5	561		15010	12	1201
DVA.2-75-55-SST-M12-37-55	75	55	M12	37	12	450		3470	14	252	410185	7510	14	546		11240	14	817
DVA.2-80-40-SST-M14-37-55	80	40	M14	37	14	510		10430	10	1043	410187	16710	10	1671		27700	10	2770
DVA.2-100-40-SST-M16-41-55	100	40	M16	41	16	740		13990	10	1399	410191	20000	10	2000		29000	10	2900
DVA.2-100-55-SST-M16-41-55	100	55	M16	41	16	850		7320	14	532	410193	13080	14	951		24260	14	1764
DVA.2-100-60-SST-M16-41-55	100	60	M16	41	16	865		7000	15	467	410195	11290	15	753		28500	15	1900
DVA.2-100-75-SST-M16-41-55	100	75	M16	41	16	980		7790	19	415	410197	9640	19	514		22350	19	1192
DVA.2-125-55-SST-M16-41-55	125	55	M16	41	16	1320		17600	14	1280	410198	19260	14	1401		23610	8	3008
DVA.2-125-75-SST-M16-41-55	125	75	M16	41	16	1600		12760	19	681	410199	19440	19	1037		24205	19	1291



Vibration damping elements